

RA12-134G (12V134Ah)

RA12-134G is GEL Standby battery with 10 + years floating design life time .The solid Gel protects no way to suffer electrolyte stratification and ensure mild corrosion, **its** special separator eradicates infection between plates to prevent short circuit. it offers extra-durable performance under extreme temperature.



Specification

Cells Per Unit	6
Voltage Per Unit	12
Capacity	134Ah@20hr-rate to 1.75V per cell @25°C
Weight	Approx. 41.5 Kg
Max. Discharge Current	1340 A (5 sec)
Internal Resistance	Approx. 6 mΩ
Operating Temperature Range	Discharge: -40°C~60°C Charge: -20°C~50°C Storage: -40°C~60°C
Normal Operating Temperature Range	25°C±5°C
Float charging Voltage	13.6 to 13.8 VDC/unit Average at 25°C
Recommended Maximum Charging Current Limit	26.8 A
Equalization and Cycle Service	14.2 to 14.4 VDC/unit Average at 25°C
Self Discharge	RITAR batteries can be stored for more than 6 months at 25°C. Self-discharge ratio less than 3% per month at 25°C. Please charge batteries before using.
Terminal	Terminal F12
Container Material	A.B.S. (UL94-HB), Flammability resistance of UL94-V1 can be available upon request.



MH28539



G4M20206-0910-E-16



ISO9001:2000 Certificate

Dimensions

Unit: mm Dimension: 340(L)×173(W)×285(H)

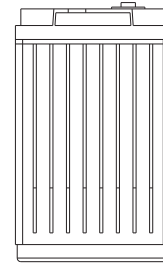
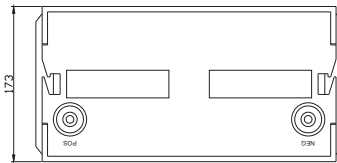
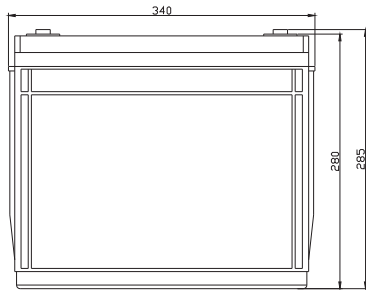

Terminal F12

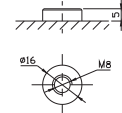

Constant Current Discharge Characteristics: A (25°C)

F.V/Time	5MIN	10MIN	15MIN	30MIN	1HR	2HR	3HR	4HR	5HR	8HR	10HR	20HR
9.60V	440.22	315.45	229.53	144.08	81.439	45.592	32.701	27.063	21.299	15.730	13.300	7.0336
10.0V	428.45	300.15	224.82	141.70	81.063	45.249	32.575	26.937	21.174	15.602	13.172	6.9057
10.2V	403.73	289.56	221.29	140.45	80.311	44.906	32.325	26.812	21.049	15.474	13.044	6.7778
10.5V	362.53	267.19	210.69	136.94	79.559	44.563	32.200	26.561	20.798	15.346	12.916	6.6500
10.8V	327.22	243.65	194.21	130.93	77.680	43.763	31.323	25.935	20.422	15.090	12.788	6.5221
11.1V	284.85	217.76	174.20	122.66	73.796	41.821	29.944	24.682	19.545	14.451	12.405	6.1384

Constant Power Discharge Characteristics: W (25°C)

F.V/Time	5MIN	10MIN	15MIN	30MIN	1HR	2HR	3HR	4HR	5HR	8HR	10HR	20HR
9.6V	4192.7	3065.9	2257.4	1626.0	931.41	524.47	377.37	312.72	246.57	182.53	149.55	78.993
10.0V	4107.0	2928.3	2210.5	1605.7	926.90	522.42	376.62	311.97	245.07	181.76	148.02	78.226
10.2V	3876.9	2830.8	2180.5	1586.9	920.13	517.62	374.37	310.47	244.32	180.23	147.25	77.459
10.5V	3491.1	2615.7	2079.2	1550.8	911.11	512.82	372.11	308.21	242.06	178.69	145.72	76.692
10.8V	3140.3	2374.9	1910.3	1480.2	888.56	505.28	363.09	299.94	238.30	174.86	144.18	75.925
11.1V	2710.7	2109.2	1705.8	1387.0	841.95	481.97	345.05	285.66	226.27	168.72	139.58	72.858

All mentioned values are average values.



Effect of temperature on long term float life



Storage characteristic

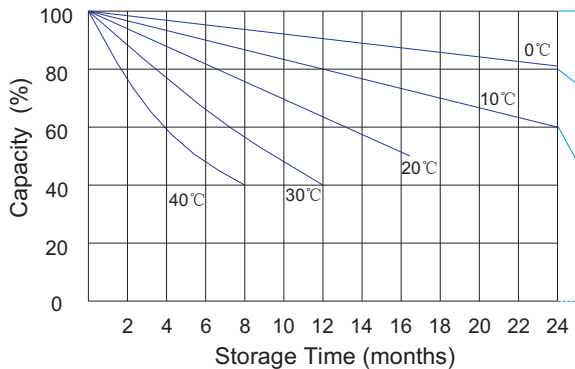

Supplementary charge required (Carry out supplementary charge before use if 100% capacity is required)

Supplementary charge required before use. This supplementary charge will help to recover the capacity and should be made as early as possible.

Supplementary charge may often fail to recover the capacity. The battery should never be left standing till this state is reached

Supplementary charge and storage guidelines

Charge characteristic Curve for standby use

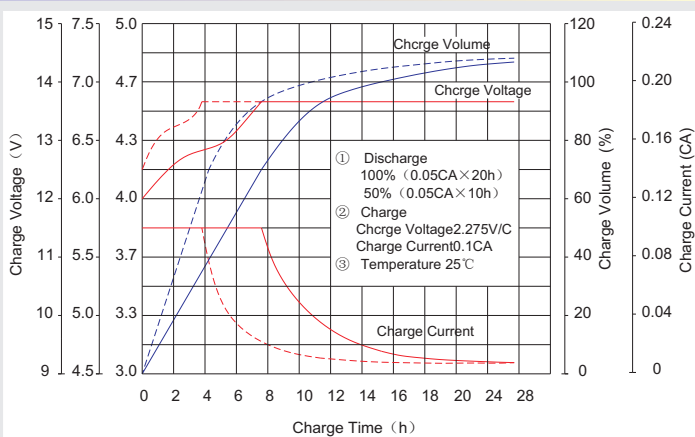

Discharge characteristic Curve

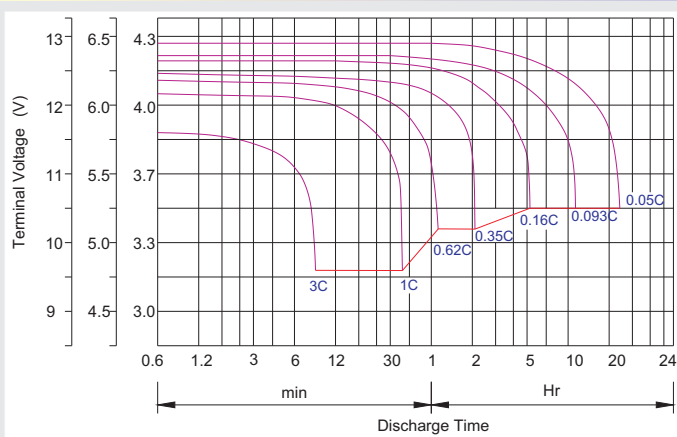

Capacity Factors With Different Temperature

Battery Type		-20°C	-10°C	0°C	5°C	10°C	20°C	25°C	30°C	40°C	45°C
GEL Battery	6V&12V	50%	70%	83%	85%	90%	98%	100%	102%	104%	105%
	2V	60%	75%	85%	88%	92%	99%	100%	103%	105%	106%
AGM Battery	6V&12V	46%	66%	76%	83%	90%	98%	100%	103%	107%	109%
	2V	55%	70%	80%	85%	92%	99%	100%	104%	108%	110%

Discharge Current VS. Discharge Voltage

Final Discharge Voltage V/cell	1.75V	1.70V	1.60V
Discharge Current (A)	(A) ≤ 0.2C	0.2C < (A) < 1.0C	(A) ≥ 1.0C

Maintenance & Cautions

Float Service:
※ Every month, recommend inspection every battery voltage.
※ Every three months, recommend equalization charge for one time.
Equalization charge method:
Discharge: 100% rate capacity discharge.
Charge: Max. current 0.2CA, constant voltage 2.35-2.4V/Cell charge 24h.
※ Effect of temperature on float charge voltage: -3mV/°C/Cell.
※ Length of service life will be directly affected by the number of discharge cycles, depth of discharge, ambient temperature and charging voltage.

Charge the batteries at least once every six months, if they are stored at 25°C.

Charging Method:

Constant Voltage	-0.2Cx2h+2.35-2.4V/cellx24h,Max. Current 0.2CA
Constant Current	-0.2Cx2h+0.1CAx12h
Fast	-0.2Cx2h+0.3CAx4.0h